

# Framed Rotating Drum



Framed rotating drum provides pass-through security. Satin anodized or duranodic bronze perimeter frame surrounds a stainless steel drum. Built in latch prevents unwanted drum rotation. Fits a rough opening of 16-1/8" wide x 18-5/8" high.



Designed, Engineered and  
Manufactured in the USA

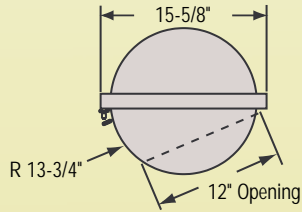

Top View

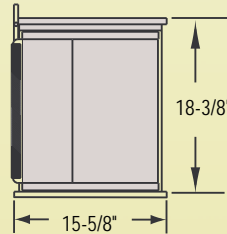

Front View

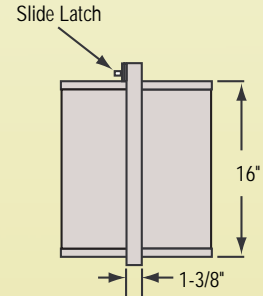

Side View

CAT. NO.	FINISH	WIDTH	HEIGHT	DEPTH
RS200DRUM	Satin Anodized Frame	15-5/8"	18-3/8"	13-3/4"
RS201DRUM	Duranodic Bronze Frame	15-5/8"	18-3/8"	13-3/4"

## SPECIFICATIONS:

**Materials:** Aluminum Extrusion; Stainless Steel Drum

**Finishes:** Brushed Stainless Steel (Drum Portion Only);  
Frame - Satin Anodized or Duranodic Bronze

**Instructions Included**